

## How to Connect Devices Unsupported by Eduroam to Liberty - Wireless

This guide provides step-by-step instructions for setting up IoT , gaming console, TV, or other devices unsupported by Eduroam on Liberty - Wireless.

### Adding a Gaming Device

1. To add an unsupported device, go to [Onboard.Liberty.edu](https://Onboard.Liberty.edu) on a device that is already connected to Liberty's network.

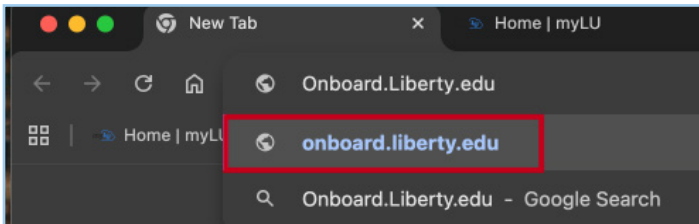

2. Click **Sign in to Manage Other Devices**.

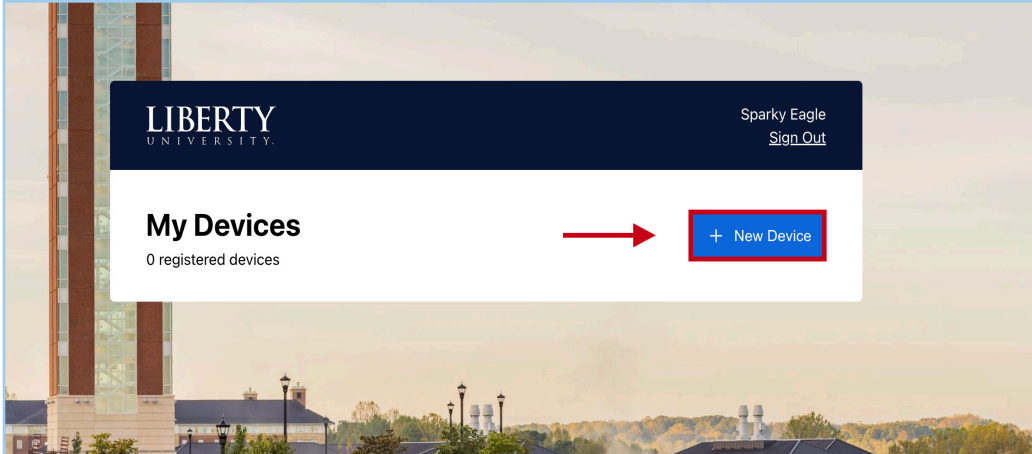

3. Sign in using your **Liberty credentials**.

A screenshot of the Liberty University sign-in page. The page shows 'LIBERTY UNIVERSITY' at the top. Below the header, there is a 'Sign in' section. The email field contains 'sparkyeagle@liberty.edu' and is highlighted with a red box. Below the email field, there is a link 'Can't access your account?'. At the bottom, there is a blue 'Next' button.A screenshot of the Liberty University password entry page. The page shows 'LIBERTY UNIVERSITY' at the top. Below the header, there is a section for 'Enter password'. The email address 'sparkyeagle@liberty.edu' is displayed above the password field. The password field contains a series of dots and is highlighted with a red box. Below the password field, there is a link 'Forgot my password'. At the bottom, there is a blue 'Sign in' button.

## Adding a Device

1. The **My Devices** page will list all of your registered devices.

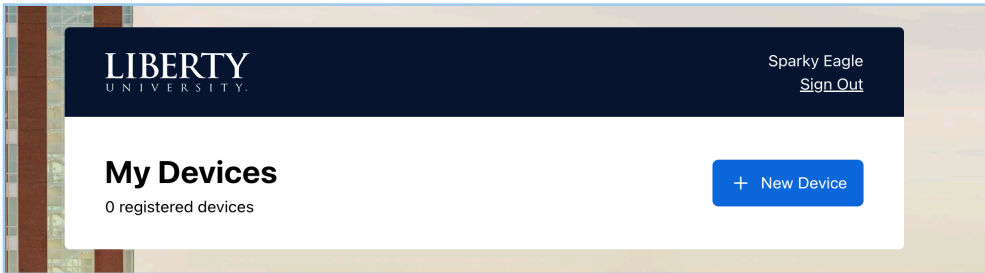

2. To register a new device, click **New Device**.

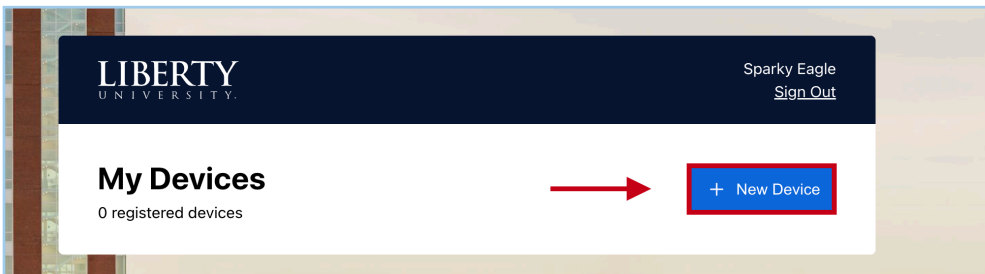

3. Enter the device details in the **Device Name** and **MAC Address** fields.

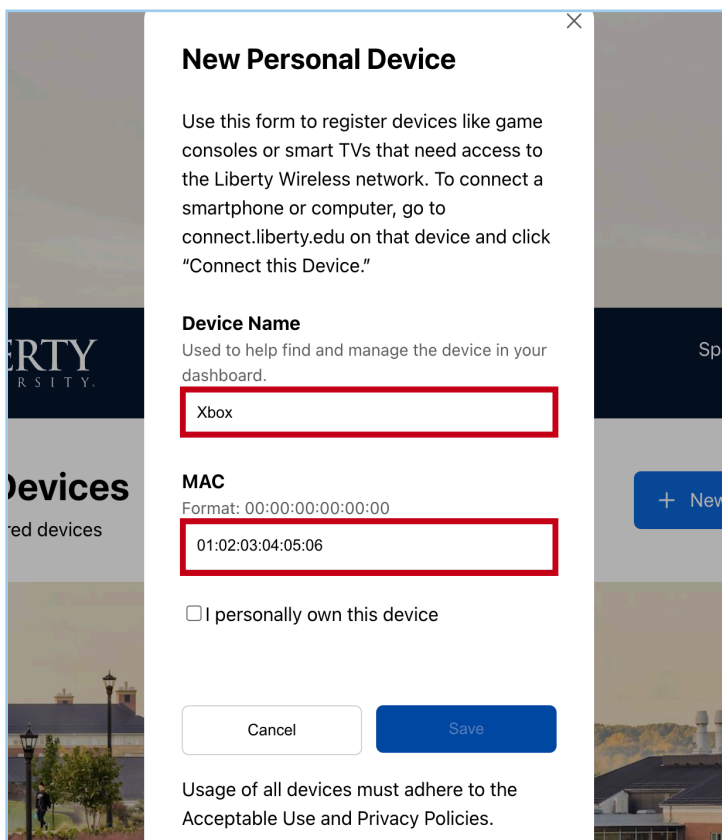
A screenshot of a "New Personal Device" registration modal window. The window title is "New Personal Device" with a close button (X) in the top right corner. The main text reads: "Use this form to register devices like game consoles or smart TVs that need access to the Liberty Wireless network. To connect a smartphone or computer, go to connect.liberty.edu on that device and click 'Connect this Device.'" Below this, there are two input fields: "Device Name" with the value "Xbox" and "MAC" with the value "01:02:03:04:05:06". The MAC field has a format hint "Format: 00:00:00:00:00:00" above it. There is an unchecked checkbox labeled "I personally own this device". At the bottom, there are "Cancel" and "Save" buttons. A footer note states: "Usage of all devices must adhere to the Acceptable Use and Privacy Policies."

**Note:** To find your device's MAC address, review [Connecting to Liberty's Wi-Fi networks \(Account access\)](#) or search the web to learn how to find the MAC address for your particular device.

4. Select **I personally own this device**, then click **Save**.

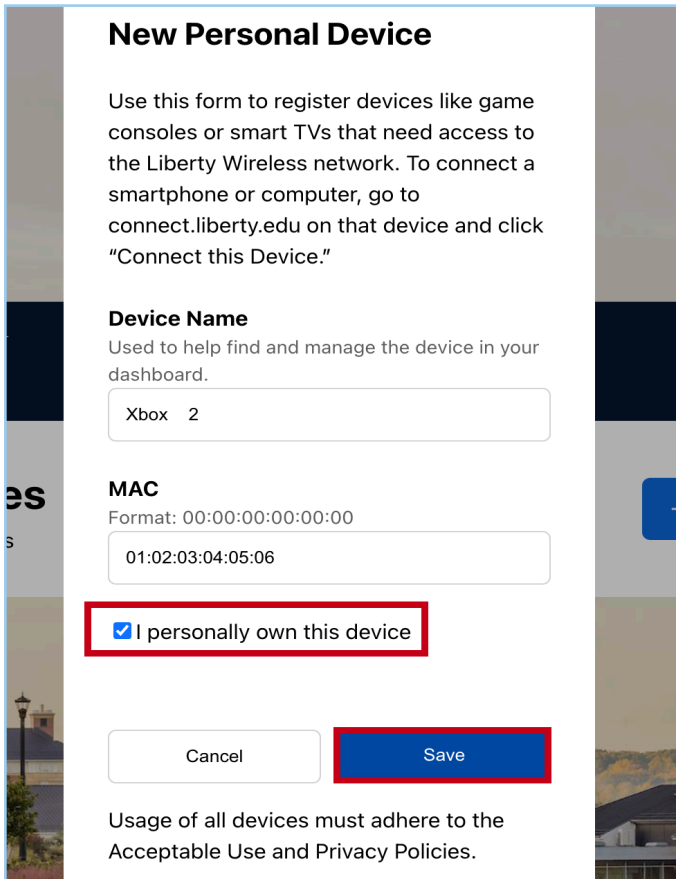

**New Personal Device**

Use this form to register devices like game consoles or smart TVs that need access to the Liberty Wireless network. To connect a smartphone or computer, go to connect.liberty.edu on that device and click "Connect this Device."

**Device Name**  
Used to help find and manage the device in your dashboard.

Xbox 2

**MAC**  
Format: 00:00:00:00:00:00

01:02:03:04:05:06

I personally own this device

Cancel Save

Usage of all devices must adhere to the Acceptable Use and Privacy Policies.

5. The device will automatically connect to **Liberty-Wireless** and appear on the **My Devices** list.

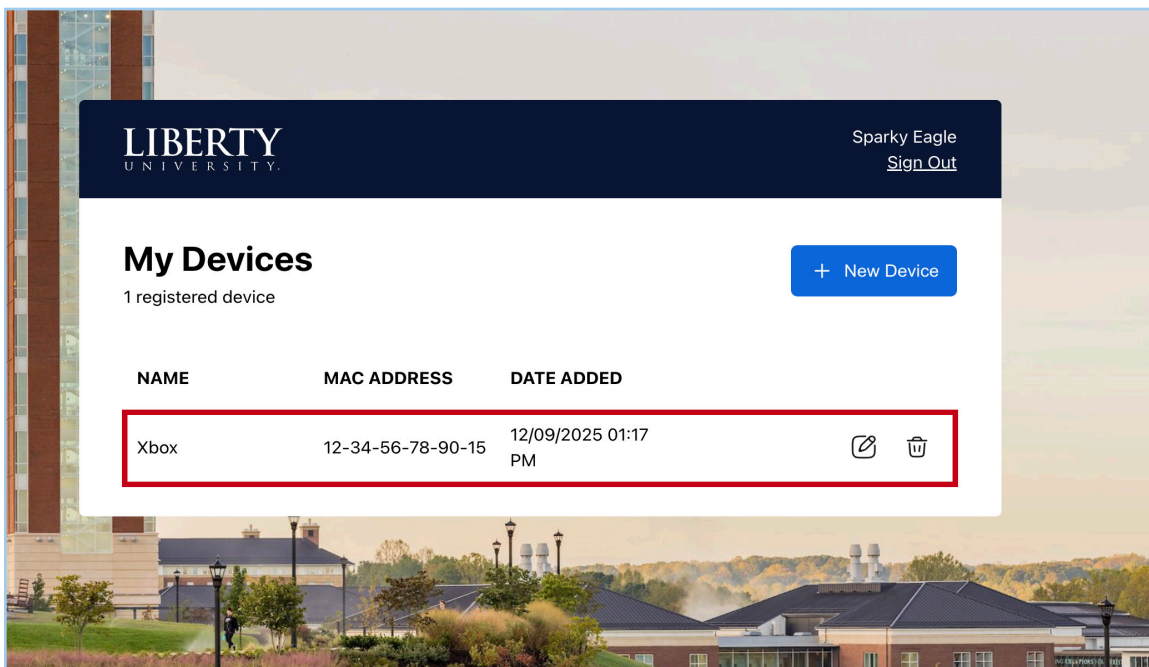



LIBERTY UNIVERSITY

Sparky Eagle  
[Sign Out](#)

**My Devices**  
1 registered device

+ New Device

NAME	MAC ADDRESS	DATE ADDED	
Xbox	12-34-56-78-90-15	12/09/2025 01:17 PM	 

**Note:** If the connected device does not work immediately, try restarting your device and reconnecting to the network.

6. To edit a registered device, click the **pencil icon** next to its name and make the necessary changes.

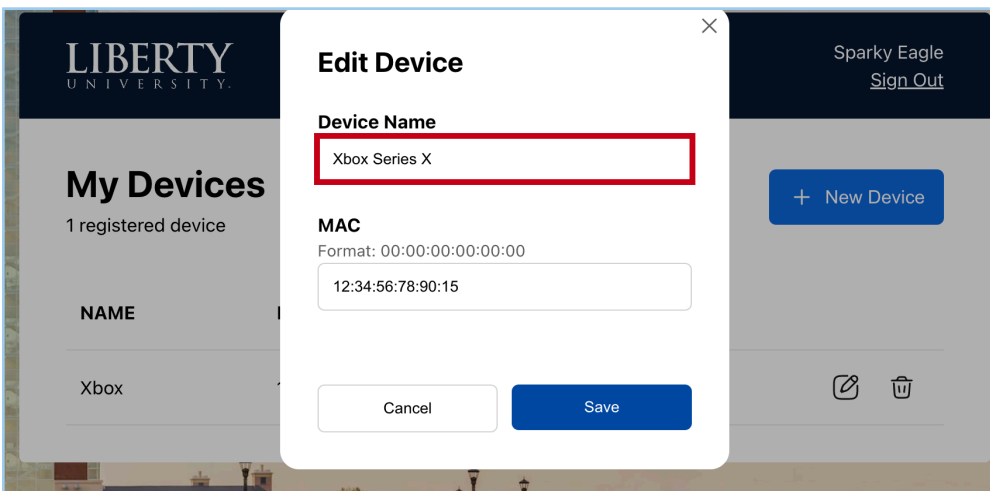
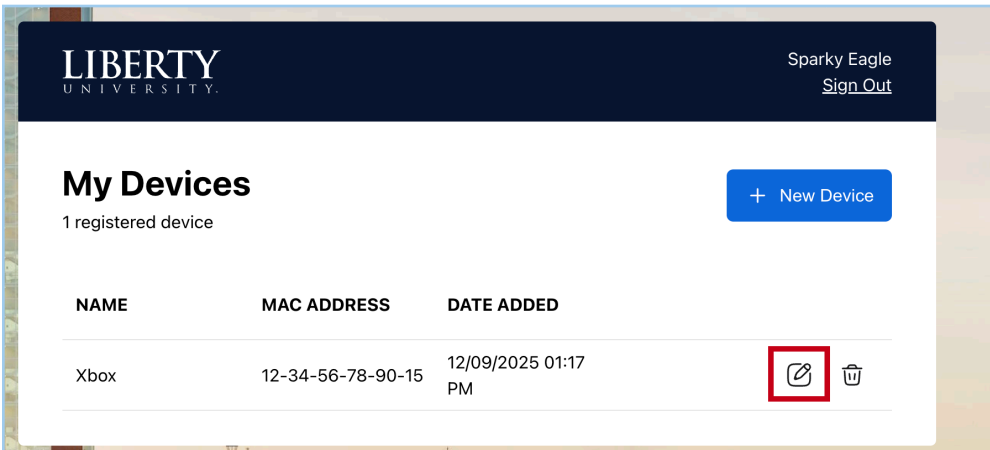

7. Click **Save**.

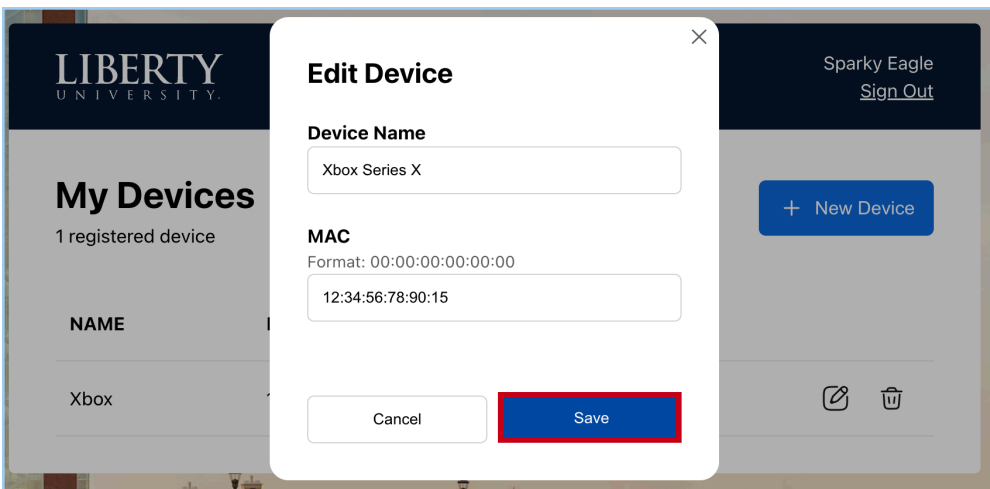

8. To remove a device, click the **trash can icon**, then confirm by selecting **Delete**.

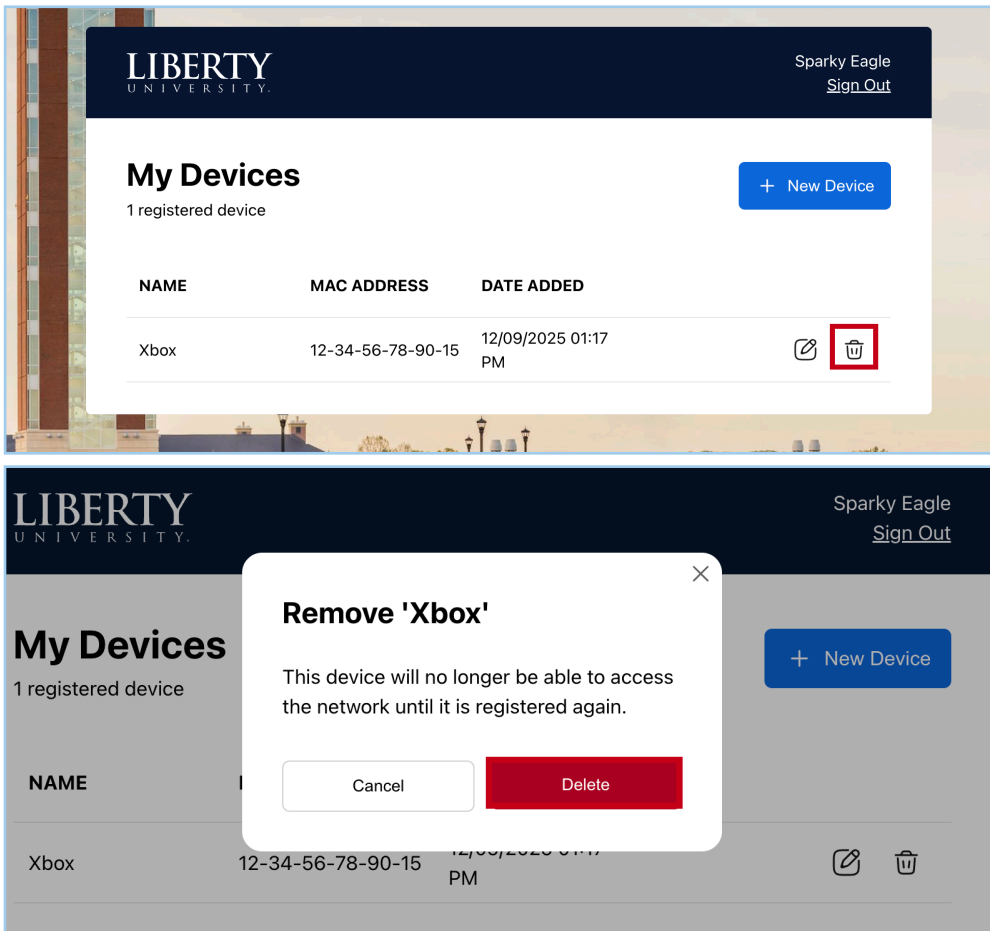

### Need Assistance?

If you need assistance completing this process or have questions about registering a new device, please contact the [IT HelpDesk](#).